

PATIO SCREEN DOOR

How to Measure

1 Determine Track Type and Measure Patio Screen Door Opening Height

If main patio door and track are vinyl, indicate below including color.

- A. Center Channel:** Measure from inside top pocket to center rail at bottom of sliding screen door track.
- B. Center Rail:** Measure tip-to-tip of center rail at top and bottom of sliding screen door track.

Take height measurements in 3 locations, left/center/right. Use the **SHORTEST** measurement for final door height and record below.

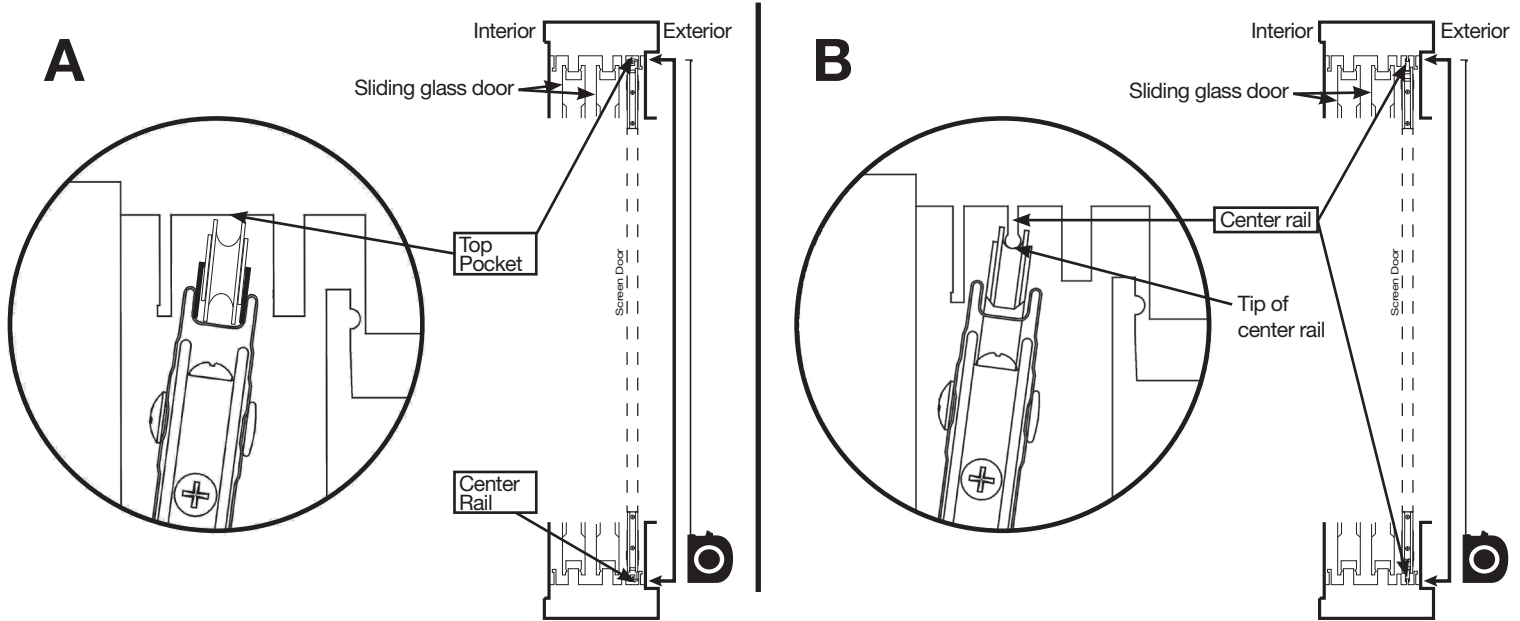

2 Measure Door Width

Measure from the surface of the side pocket where the patio screen door will latch to the far edge of the vertical stile of the main patio door stationary glass panel and record below. (see diagram A)

3 Determine Handle Side

Looking from the outside of the door in, specify placement of handle as either right or left. (Left showing in diagram)

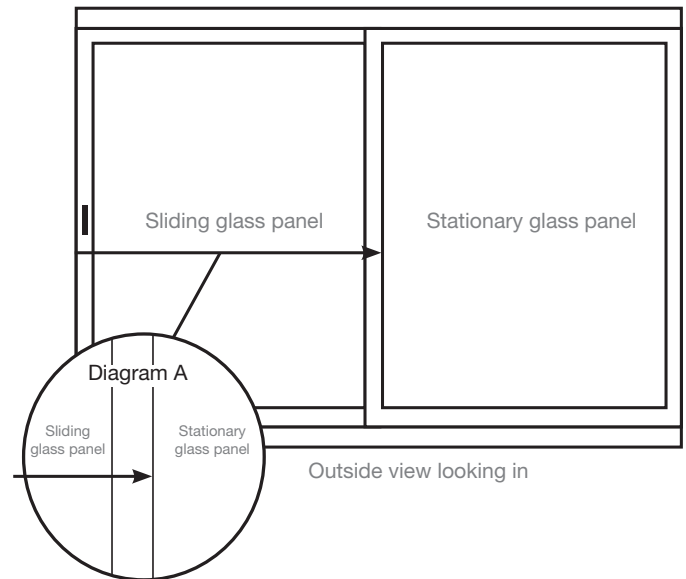

Door Width		Main Patio Door Type and Color	<input type="checkbox"/> Metal <input type="checkbox"/> Vinyl <input type="checkbox"/> White <input type="checkbox"/> Almond
Door Height		Handle Side	<input type="checkbox"/> Right <input type="checkbox"/> Left